

DG20

Sight Glass, Tubular Type with Flange Connections

- for visual control of flow and level
- applicable for liquids and gases
- 360° all-round view
- flange connections on both sides according to DIN EN 1092-1, form B
- DN 15 to DN 200, PN 10/16
ANSI ½" bis 8", 150 lbs
- glass: borosilicate glass
Flanges: steel H11 or stainless steel
- intensive to contamination
- max. pressure 16 bar (depending on nominal size)
- max. temperature: 300 °C



Description:

The sight glasses of the type series DG20 are extremely robust due to their design and can be used very functionally. They allow the inspection of filling and flow in pipelines.

The sight glass with flange connection is installed in the piping system with the appropriate sealing surfaces and enables reliable 360° monitoring of the function and performance of individual apparatus as well as of entire plants.

The DG20 sight glass is designed with flanges on both sides to suit DIN EN 1092-1, form B (PN 10/16) or ANSI.

Depending on the nominal size, pressures up to 16 bar are permissible.

The flow sight glass has no dead spaces, so that when the product is changed, the flow sight glass can be flushed / cleaned together with the pipeline.

There are almost no sediments in the sight glass when the pipeline is drained because the inside diameter of the sight glass corresponds to the inside diameter of the pipeline.

Typical Applications:

The sight glasses can be used in almost all pipelines. The borosilicate glass used allows the devices to be used for chemically very aggressive media. They are insensitive to contamination, as the inner surface is always rinsed by the flowing medium.

The sight glasses are therefore also excellently suited for sterile and antiseptic applications.

Technical Data:

Max. temperature: 300 °C

Max. Pressure: Up to DN 50: 16 bar
DN 65 up to DN 100: 10 bar
DN 125: 8 bar
DN 150: 7 bar
DN 200: 5 bar

Materials:

Flanges:	St. steel 1.4571	Steel H II (1.0425)
Screws (strength):	A4-70	5.6 zinc plated
Glass tube:	Borosilicate glass (DURAN)	
Gaskets:	FKM, PTFE, Klingersil, NBR, graphite	

Dimensions DIN Flange:

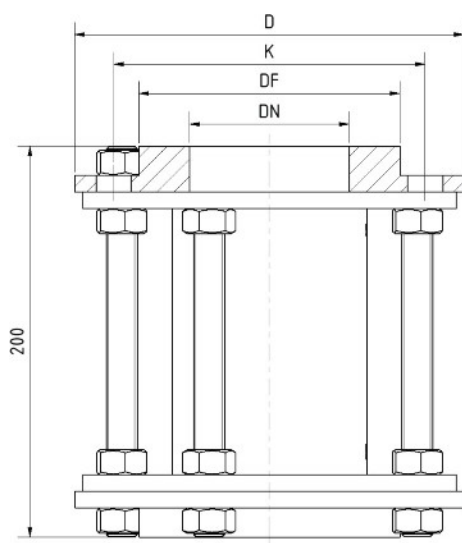

Nominal size	D [mm]	d [mm]	LK [mm]	Screws	Weight [kg]
DN 15	95	41	65	4	2,1
DN 20	105	54	75	4	2,5
DN 25	115	64	85	4	2,9
DN 32	145	74	100	4	5,6
DN 40	150	84	110	4	6,4
DN 50	175	98	125	4	7,5
DN 65	195	118	145	4	8,9
DN 80	200	134	160	4	9,6
DN 100	225	154	180	4	11,5
DN 125	250	184	210	8	12,3
DN 150	295	208	240	8	19,5
DN 200	345	264	295	8	26,2

Order Code:

Order number: DG20. D. 15. 1. F. 0. 2. 0

Sight glass, tubular type with flange connections

Process connection:

D = DIN flange (DIN EN 1092-1), form B, PN 10/16
A = ANSI flange, 150 lbs

Nominal size:

15 = DN 15 / 1/2"
20 = DN 20 / 3/4"
25 = DN 25 / 1"
32 = DN 32 / 1 1/4"
40 = DN 40 / 1 1/2"
50 = DN 50 / 2"
65 = DN 65 / 2 1/2"
80 = DN 80 / 3"
100 = DN 100 / 4"
125 = DN 125 / 5"
150 = DN 150 / 6"
200 = DN 200 / 8" (other sizes on request)

Flange material:

1 = Steel H II (P265GH)
2 = Stainless steel 1.4571

Gaskets:

F = FKM (max. 200 °C)
P = PTFE, (max. 200 °C)
K = C4400 Klingersil (max. 175 °C)
N = NBR (max. 80 °C)
G = Graphite: (max. 300 °C)

Protection jacket:

0 = without protection jacket
1 = with protection jacket of acrylic glass (max. 70 °C)
2 = with protection jacket of stainless steel perforated plate

Length:

2 = 200 mm (Standard)

Option:

0 = without
9 = please specify in plain text

Protection Jacket:

An impact protection jacket made of Plexiglas or stainless steel perforated plate can be used to protect the sight glass. The elastic plastic used is particularly UV-resistant and insensitive to impact and aging.

