

# DG10

## Sight Flow Indicator with Threaded Connection

- applicable for liquids and gases
- standard models with fully clear bore or drip tube, flap or rotor optionally available
- materials: cast iron, cast steel or stainless steel
- for pipe sizes from 1/4" to 2"
- for media-temperature up to 300 °F / 150 °C, higher ratings up to 536 °F/ 280 °C optionally available
- pressure rating: 232 psi/ PN1 6, 363 psi/ PN 25, 580 psi/ PN 40, higher pressure ranges optionally available



### Description:

DG10 sight glasses are used to visually monitor the flow of liquids in pipe systems.

Depending on the type of liquid and flow volume, these devices are used with a fully clear bore or with a flap or rotor (for transparent liquids).

DG10 sight glasses permit reliable monitoring of the function and performance of single devices or entire systems.

### Models:

### Typical Applications:

Because they are available in a variety of materials and designs, DG10 sight glasses can be used in almost any kind of pipe system.

- DG10.S:** standard model with fully clear bore, sizes G 1 1/4 and above with drip tube (can be installed in any position)
- DG10.K:** with flap (can only be installed horizontally or for upward vertical flows)
- DG10.RK:** with rotor made of POM (Tmax. 248 °F / 120 °C, can be installed in any position, but axis horizontal), for liquids only
- DG10.RP:** with rotor made of PTFE (Tmax. 500 °F/ 260 °C, can be installed in any position, but axis horizontal), for liquids only

**Consider flow direction!**

### Housing Materials (wetted parts):

- DG10.x.G:** cast iron GG 25 (EN-GJL-250) varnished
- DG10.x.S:** cast steel GS-C 25 (1.0619/GP2406H)
- DG10.x.E:** stainless steel 1.4408

### Sight Glass Materials:

- DG10.x.x.N:** soda lime glass (Tmax. 300 °F/ 150 °C) DIN 8902
- DG10.x.x.B:** borosilicate glass (Tmax. 280 °C) DIN 7080

### Dimensions:

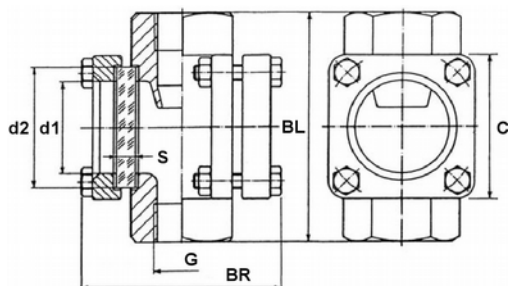

Con- nection	Qmax [l/min]*	BL [mm]	d1 [mm]	d2 [mm]	S [mm] 16 bar	C [mm]	BR [mm]
1/4"	9						
3/8"	14	100	32	45	10	70	95
1/2"	30						
3/4"	56	120	48	63	10	85	100
1"	88						
1 1/4"	144	160	65	80	12	116	125
1 1/2"	226						
2"	350	230 (GG: 180)	80	100	15	120	150

\* with Rotor

### Weight (without installation):

Connection	Cast Iron	Cast Steel or Stainless Steel
1/4"	2,2 kg	2,2 kg
3/8"+1/2"	2,2 kg	2,2kg
3/4"+1"	3,5 kg	3,5 kg
1 1/4"+1 1/2"	7,0 kg	7,0 kg
2"	10,0 kg	10,5 kg

### Order Code:

Order Number: **DG10.** **RK.** **E.** **B.** **25.** **16.** **0**

**Flow sight glass with threaded connections (female)**

#### Designs:

- S = standard design with fully clear bore (sizes 1 1/4" and above with drip tube)
- K = with flap
- RK = with plastic rotor (POM) (not for 2")
- RP = with plastic rotor (PTFE)

#### Housing materials:

- G = cast iron (PN 16 only)
- S = cast steel
- E = stainless steel

#### Sight glass materials:

- N = soda lime glass
- B = borosilicate glass

#### Process connection (female):

- 08 = G 1/4                      08N = 1/4" NPT
- 10 = G 3/8                     10N = 3/8" NPT
- 15 = G 1/2                     15N = 1/2" NPT
- 20 = G 3/4                     20N = 3/4" NPT
- 25 = G 1                        25N = 1" NPT
- 32 = G 1 1/4                  32N = 1 1/4" NPT
- 40 = G 1 1/2                  40N = 1 1/2" NPT
- 50 = G 2 female              50N = 2" NPT
- NPT- thread with cast steel + stainless steel

#### Pressure rating:

- 16 = 232 psi/ PN 16 (standard)
- 25 = 363 psi/ PN 25 (only cast steel or st. st. with borosilicate gl.)
- 40 = 580 psi/ PN 40 (only cast steel or st. st. with borosilicate gl.)

#### Options:

- 0 = without
- 1 = Please specify in plain text

### Technical Data:

**Materials:** housing and sight glass: see description  
gasket: graphite  
(other gasket materials available on request)

**Max. pressure:** 232 psi/ PN 16 standard

580 psi/ PN 40 standard at size DN 08, 10 and 15 at cast steel or stainless steel

363 psi/ PN 25 and 580 psi/ PN 40 only optionally for cast steel + stainless steel

#### Max. media-temperature:

**DG10.S/K...:** 300 °F/ 150 °C (536 °F/ 280 °C with borosilicate glass)

**DG10 RK...:** 248 °F/ 120 °C

**DG10.RP...:** 300 °F/ 150 °C (500 °F/ 260 °C with borosilicate glass)

### Special Designs:

Flow sight glasses with welding ends

